

#### GENERAL SPECIFICATION

- Lug back fitting
- Adjustable dial
- Tolerance pointers
- Bezel lock
- Hardened and ground racks
- Ball anvil probe

Product Code	Dial Dia	Travel	Grads	Reading	Dial Colour
DG-5M	40mm	5.0mm	0.01mm	0-100 c/w	White
DG-M	60mm	10.0mm	0.01mm	0-100 c/w, 0-100 a/c	White
DG-MB	60mm	10.0mm	0.01mm	0-100 c/w, 0-100 a/c	Black
DG-25M	60mm	25.0mm	0.01mm	0-100 c/w, 0-100 a/c	White
DG-25MB	60mm	25.0mm	0.01mm	0-100 c/w, 0-100 a/c	Black
DG-50M	76mm	50.0mm	0.01mm	0-100 c/w, 0-100 a/c	White
DG-1/4	1.58"	0.25"	0.001"	0-100 c/w	White
DG-1/2S	2.35"	0.50"	0.001"	0-100 c/w, 0-100 a/c	White
DG-1/2SB	2.35"	0.50"	0.001"	0-100 c/w, 0-100 a/c	Black
DG-1S	2.35"	1.0"	0.001"	0-100 c/w, 0-100 a/c	White
DG-1SB	2.35"	1.0"	0.001"	0-100 c/w, 0-100 a/c	Black
DG-2S	3.0"	2.0"	0.001"	0-100 c/w, 0-100 a/c	White

#### ACCURACY SPECIFICATION // METRIC MODELS

Range	Grads	Total Revolutions	Each 0.1mm	Each 0.5mm	Each 1.0mm	Each 2.0mm	Total Travel
0-5mm	0.01mm	5	0.005mm	0.008mm	0.010mm	0.015mm	0.016mm
0-10mm	0.01mm	10	0.005mm	0.008mm	0.010mm	0.015mm	0.020mm
0-25mm	0.01mm	25	0.005mm	0.008mm	0.010mm	0.015mm	0.030mm
0-50mm	0.01mm	50	0.010mm	0.015mm	0.020mm	0.025mm	0.045mm

#### ACCURACY SPECIFICATION // INCH MODELS

Range	Grads	Total Revolutions	Any 2 Revolutions	First 10 Revolutions	First 20 Revolutions	Total Travel
0-1/4"	.001"	2-1/2	.001"	-	-	.0012"
0-1/2"	.001"	5	.001"	-	-	.0015"
0-1"	.001"	10	.001"	.002"	-	.002"
0-2"	.001"	20	.001"	.002"	.004"	.004"

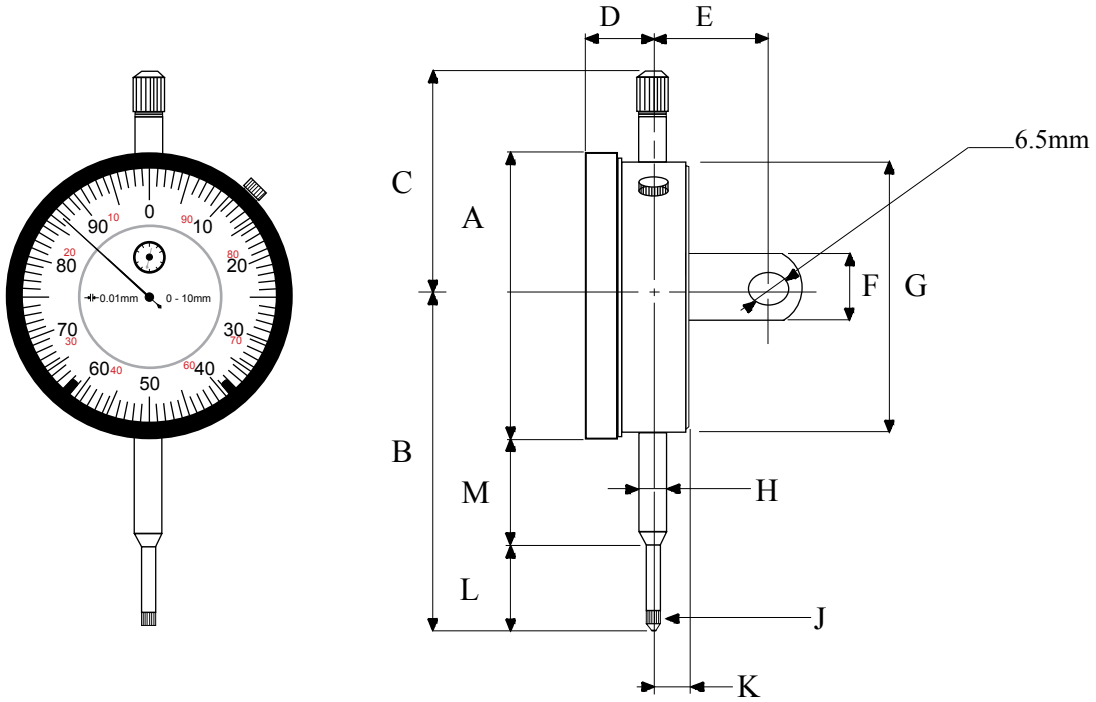

#### DIMENSIONS // METRIC MODELS

Product Code	A	B	C	D	E	F	G	H	J	K	L	M
DG-5M	40.0	46.0	30.0	12.8	17.7	17.8	36.0	8.0	M2.5	6.3	12.5	13.5
DG-M	60.0	69.0	45.0	16.0	19.3	17.8	54.7	8.0	M2.5	8.0	20.0	18.0
DG-MB	60.0	69.0	45.0	16.0	19.3	17.8	54.7	8.0	M2.5	8.0	20.0	18.0
DG-25M	60.0	84.0	40.0	16.0	19.3	17.8	54.7	8.0	M2.5	8.0	36.3	18.0
DG-25MB	60.0	84.0	40.0	16.0	19.3	17.8	54.7	8.0	M2.5	8.0	36.3	18.0
DG-50M	76.0	130.0	48.0	16.4	23.2	17.8	71.0	8.0	M2.5	8.0	59.0	33.0

#### DIMENSIONS // INCH MODELS

Product Code	A	B	C	D	E	F	G	H	J	K	L	M
DG-1/4	1.58	1.92	1.19	0.53	0.69	0.7	1.41	8.0mm	M2.5	0.25	0.60	0.51
DG-1/2S	2.35	3.02	1.54	0.63	0.77	0.7	2.16	8.0mm	M2.5	0.32	1.08	0.73
DG-1/2SB	2.35	3.02	1.54	0.63	0.77	0.7	2.16	8.0mm	M2.5	0.32	1.08	0.73
DG-1S	2.35	3.36	1.52	0.63	0.77	0.7	2.16	8.0mm	M2.5	0.32	1.42	0.73
DG-1SB	2.35	3.36	1.52	0.63	0.77	0.7	2.16	8.0mm	M2.5	0.32	1.42	0.73
DG-2S	3.0	5.45	4.37	0.61	0.77	0.7	2.16	8.0mm	M2.5	0.32	2.28	1.68