

DATA - SHEET 1036

No. 1036

Page. 1 of 1

Date. 01 / 08 / 2005

Screw Plug Gauges - Metric Coarse

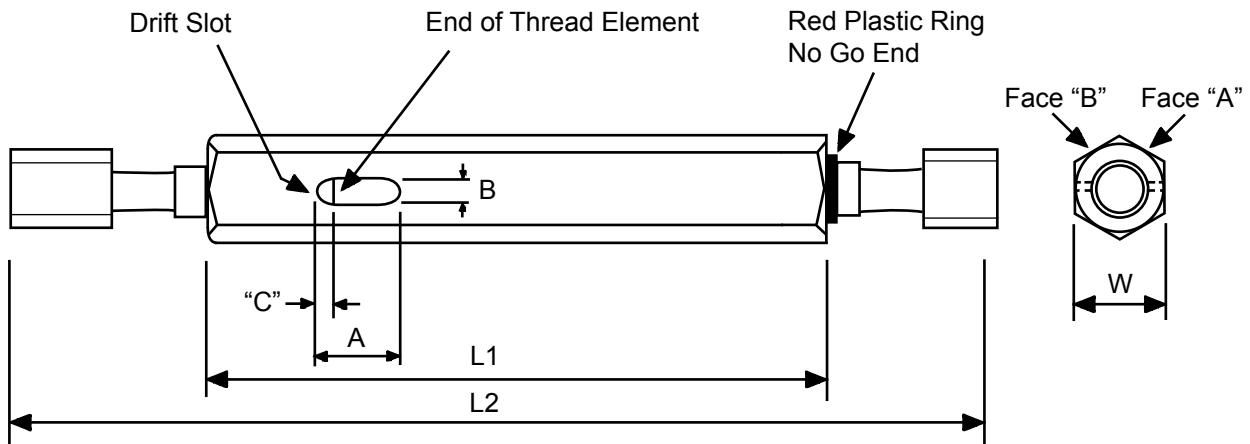

GENERAL DIMENSIONS

ThreadSize	L1	L2 Max	A	B	C Min	C Max	W Max
M3	40mm	60mm	6mm	2mm	2mm	3mm	5mm
M4	48mm	72mm	8mm	2mm	2mm	4mm	7mm
M5	48mm	72mm	8mm	2mm	2mm	4mm	7mm
M6	48mm	72mm	8mm	2mm	2mm	4mm	7mm
M8	56mm	88mm	8mm	3mm	2mm	4mm	10mm
M10	56mm	94mm	10mm	4mm	3mm	5mm	11mm
M12	63mm	106mm	12mm	4mm	4mm	6mm	11mm
M14	70mm	115mm	6mm dia.	6mm dia.	2mm	3mm	14mm
M16	70mm	115mm	6mm dia.	6mm dia.	2mm	3mm	14mm
M20	80mm	140mm	9mm dia.	9mm dia.	2mm	4mm	17mm

MARKING SPECIFICATIONS



CODE NO.	SIZE	(PITCH DIA A)	CLASS	(PITCH DIA B)
53-800-030	M3 x .05	2.675mm	ISO 6H	2.775mm
53-800-040	M4 x 0.7	3.545mm	ISO 6H	3.663mm
53-800-050	M5 x 0.8	4.480mm	ISO 6H	4.605mm
53-800-060	M6 x 1.0	5.350mm	ISO 6H	5.500mm
53-800-080	M8 x 1.25	7.188mm	ISO 6H	7.348mm
53-800-100	M10 x 1.5	9.026mm	ISO 6H	9.206mm
53-800-120	M12 x 1.75	10.863mm	ISO 6H	11.063mm
53-800-140	M14 x 2.0	12.701mm	ISO 6H	12.913mm
53-800-160	M16 x 2.0	14.701mm	ISO 6H	14.913mm
53-800-200	M20 x 2.5	18.376mm	ISO 6H	18.600mm