

**DATA - SHEET 1037**

**No. 1037**

**Page. 1 of 1**

**Date. 01 / 08 / 2005**

**Screw Plug Gauges - Fine**

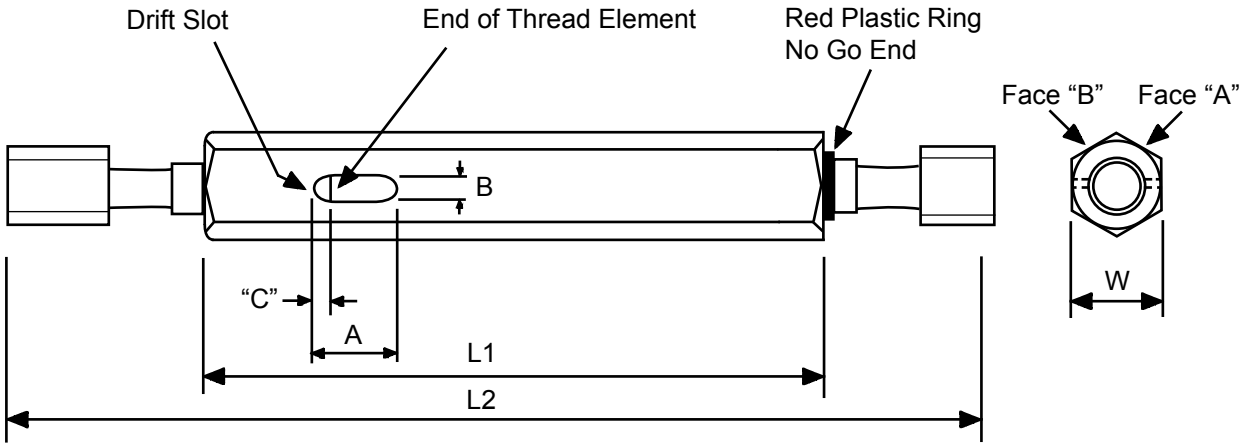

**GENERAL DIMENSIONS**

ThreadSize	L1	L2 Max	A	B	C Min	C Max	W Max
M4	48mm	72mm	8mm	2mm	2mm	4mm	7mm
M6	48mm	72mm	8mm	2mm	2mm	4mm	9mm
M8	56mm	88mm	8mm	3mm	2mm	4mm	9mm
M10	56mm	94mm	10mm	4mm	3mm	5mm	10mm
M12	63mm	106mm	12mm	4mm	4mm	6mm	11mm

**MARKING SPECIFICATIONS**

GO PD	(SIZE)	NO GO PD
(PITCH DIA. A)	(CLASS)	(PITCH DIA. B)

← Face "B"  
← Face "A"

CODE NO.	SIZE	(PITCH DIA A)	CLASS	(PITCH DIA B)
53-800-041F	M4 x 0.5	3.673mm	ISO 6H	3.775mm
53-800-061F	M6 x 0.75	5.513mm	ISO 6H	5.675mm
53-800-081F	M8 x 1.0	7.350mm	ISO 6H	7.500mm
53-800-101F	M10 x 1.25	9.188mm	ISO 6H	9.348mm
53-800-121F	M12 x 1.25	11.188mm	ISO 6H	11.368mm