

DATA - SHEET 1038

No. 1038

Page. 1 of 1

Date. 01 / 08 / 2005

Screw Plug Gauges - UNC

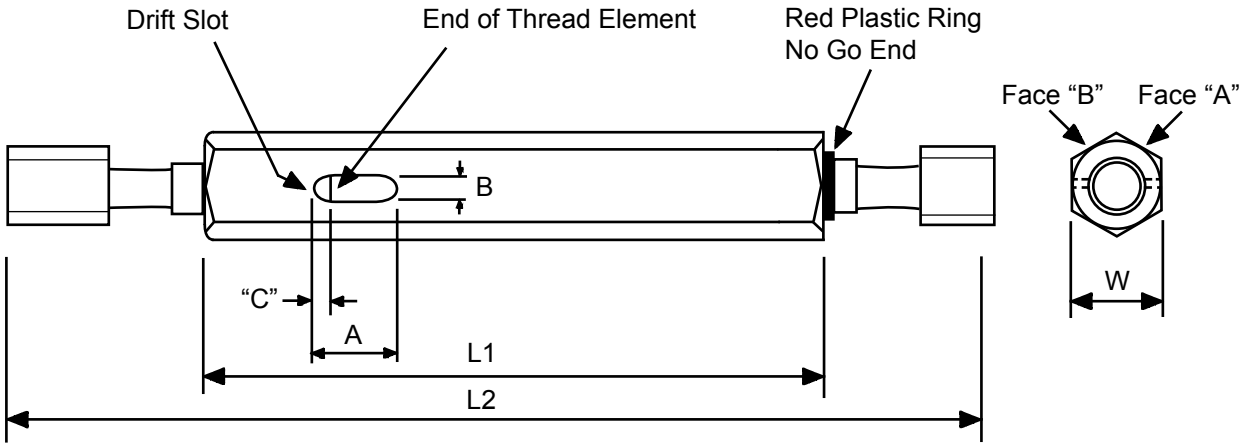

GENERAL DIMENSIONS

| Thread Size | L1 | L2 Max | A | B Min | C Max | C | W Max |
|---------------|------|--------|------|-------|-------|-----|-------|
| 4 - 40 UNC | 48mm | 72mm | 8mm | 2mm | 2mm | 4mm | 7mm |
| 1/4 - 20 UNC | 56mm | 88mm | 8mm | 3mm | 2mm | 4mm | 7mm |
| 5/16 - 18 UNC | 56mm | 88mm | 8mm | 3mm | 2mm | 4mm | 7mm |
| 3/8 - 16 UNC | 56mm | 94mm | 10mm | 4mm | 3mm | 5mm | 10mm |
| 1/2 - 13 UNC | 63mm | 106mm | 12mm | 4mm | 4mm | 6mm | 11mm |

MARKING SPECIFICATIONS

| | | |
|---------------|---------|----------------|
| GO PD | (SIZE) | NO GO PD |
| (PITCH DIA A) | (CLASS) | (PITCH DIA. B) |

← Face "B"

← Face "A"

| CODE NO. | SIZE | (PITCH DIA A) | CLASS | (PITCH DIA B) |
|------------|---------------|---------------|-------|---------------|
| 53-810-000 | 4 - 40 UNC | 0.0958 | 2B | 0.0991 |
| 53-810-001 | 1/4 - 20 UNC | 0.2175 | 2B | 0.2223 |
| 53-810-002 | 5/16 - 18 UNC | 0.2764 | 2B | 0.2817 |
| 53-810-003 | 3/8 - 16 UNC | 0.3344 | 2B | 0.3401 |
| 53-810-004 | 1/2 - 13 UNC | 0.4500 | 2B | 0.4565 |