

**DATA - SHEET 1039**

**No. 1039**

**Page. 1 of 1**

**Date. 01 / 08 / 2005**

**Screw Plug Gauges - UNF**

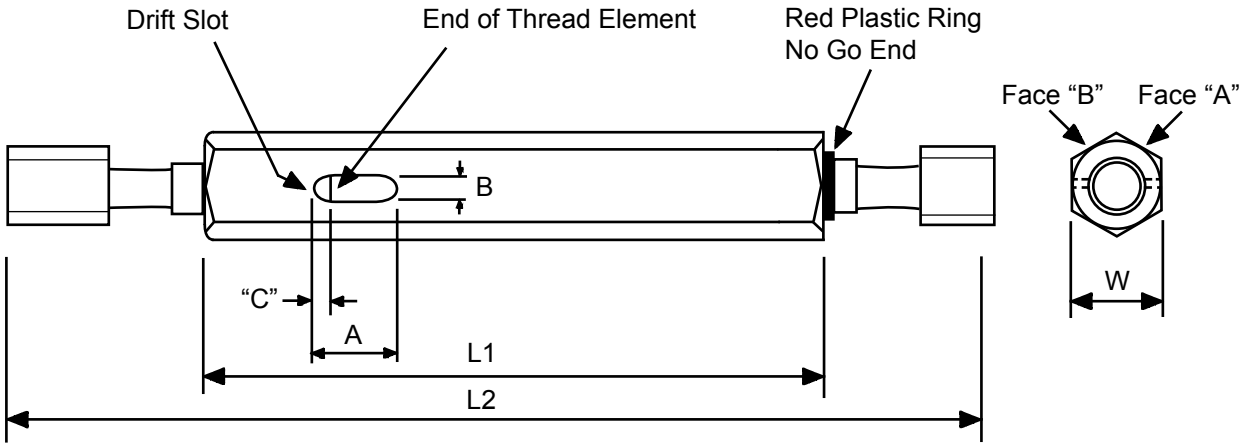

**GENERAL DIMENSIONS**

Thread Size	L1	L2 Max	A	B	C Min	C Max	W Max
1/4 - 28 UNF	56mm	88mm	8mm	3mm	2mm	4mm	8.85mm
5/16 - 24 UNF	56mm	88mm	8mm	3mm	2mm	4mm	9mm
3/8 - 24 UNF	56mm	94mm	10mm	4mm	3mm	5mm	10mm
1/2 - 20 UNF	63mm	106mm	12mm	4mm	4mm	6mm	11mm

**MARKING SPECIFICATIONS**

GO PD	(SIZE)	NO GO PD	← Face "B"
(PITCH DIA A)	(CLASS)	(PITCH DIA. B)	← Face "A"

CODE NO.	SIZE	(PITCH DIA A)	CLASS	(PITCH DIA B)
53-820-001	1/4 - 28 UNF	0.2268	2B	0.2311
53-820-002	5/16 - 24 UNF	0.2854	2B	0.2902
53-820-003	3/8 - 24 UNF	0.3479	2B	0.3528
53-820-005	1/2 - 20 UNF	0.4675	2B	0.4731