

## DATA - SHEET 1045

**No. 1045**

**Page. 1 of 1**

**Date. 15 / 11 / 2005**

### Revolving Centres - Pipe

- \* Medium Duty
- \* Point Angle: 60°
- \* Fully sealed bearings

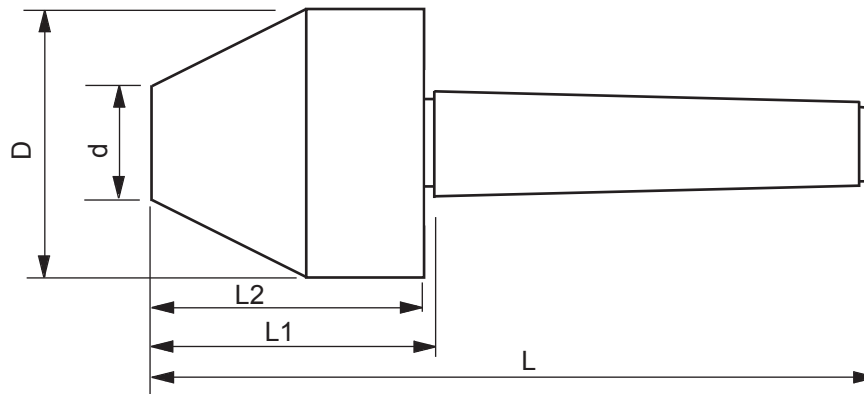

Code	Size	d	D	D1	L	L1	L2
	MT	mm	mm	mm	mm	mm	mm
RCP-03	3	30	81.5	24.1	161	76.5	73

Code	Workpiece	Speed	Conc.	Weight
	weight	Max.	error	approx
	max. kg	Min-1	max.	kg
RCP-03	400	4500	0.008	2.0