

'G' Clamp Vice 52-195-625

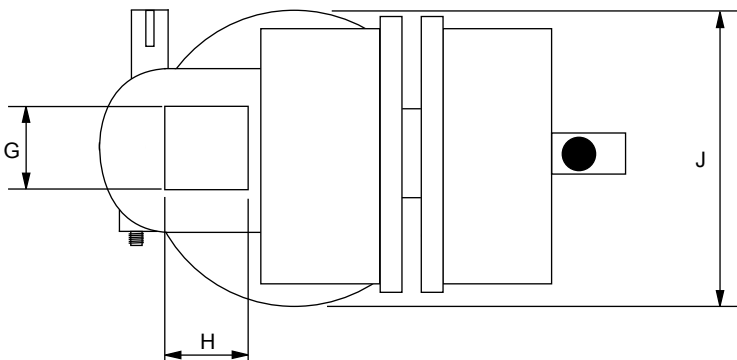
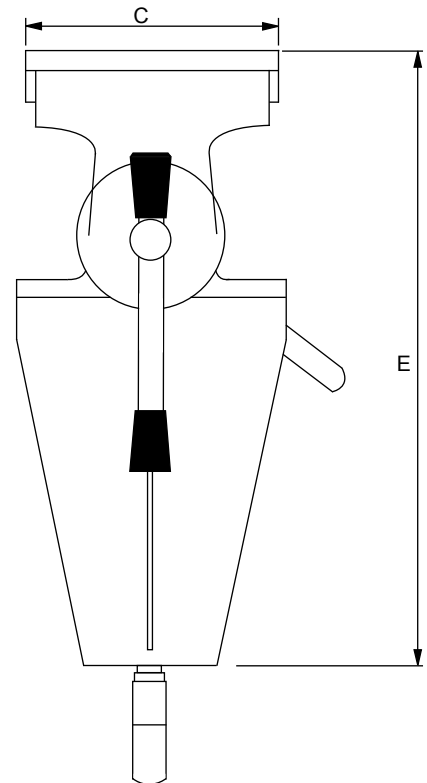
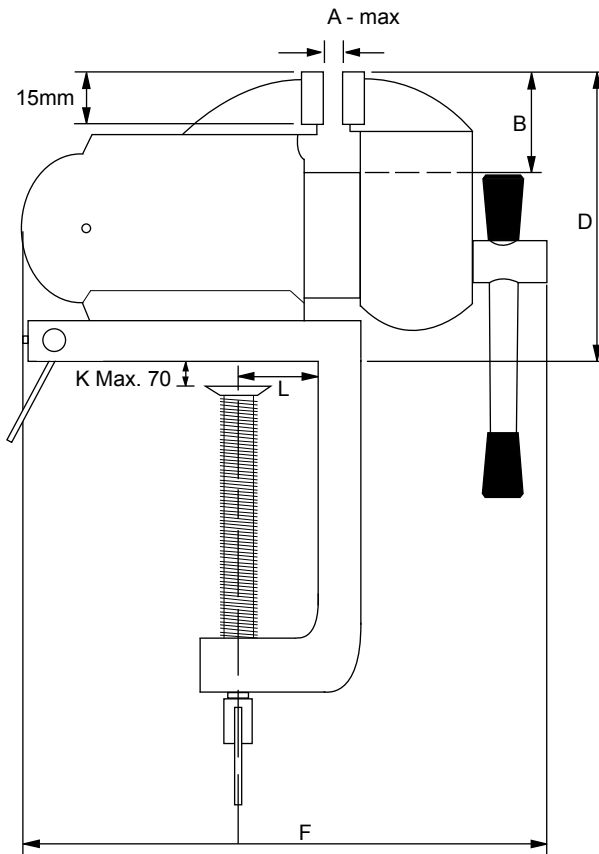

Vice Jaw Tolerances:

Clamping faces:

Closed position, parallel within 0.01mm

Top faces:

Closed position, flat & parallel within 0.05mm

Side faces:

Closed position, flat & parallel within 0.1mm

A	B	C	D	E	F	G	H	J	K	L	WEIGHT
40mm	32mm	63mm	90mm	180mm	155mm	28mm	25mm	70mm	70mm	23mm	2.48 Kilos